

# Krause LS Jet

## Highest Value CTP

**KRAUSE**  
Quality builds trust.



The Krause LS Jet is the high performance CTP platesetter from Krause ranked top in its class. Available in seven different models from 120 to 300 pph capacity it is the fastest platesetter in the marketplace and the unique features in regards of platehandling, automation and image quality make it the perfect solution for high volume newspaper and selected commercial CTP production. Krause engineering and Violet technology guarantee highest reliability and lowest operating costs.

### Unique features and benefits provided by Krause LS Jet :

- fastest platesetter with 60/120mW Violet laser diodes for up to 300 plates per hour
- reduced floorspace with mirrored machine design and multi-direction plate output
- highest quality by Juwel optics with smallest spot size in existing newspaper plate imaging
- upgradable for future growth from 120 to 300 plates per hour
- easy workflow integration via NetLink 1 Bit Tiff interface
- integrated Double Media Sensor with automatic plate eject for manless operation
- reduced service costs with NetCare Remote Service and high quality engineering
- user friendly operation and open system design with perfect access to all components
- compatible with future Violet plate technologies

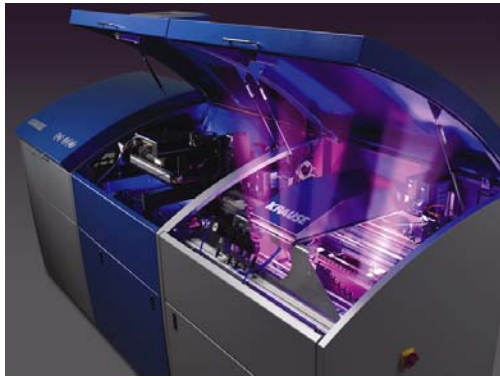

Krause LS Jet : the fastest Violet CTP system

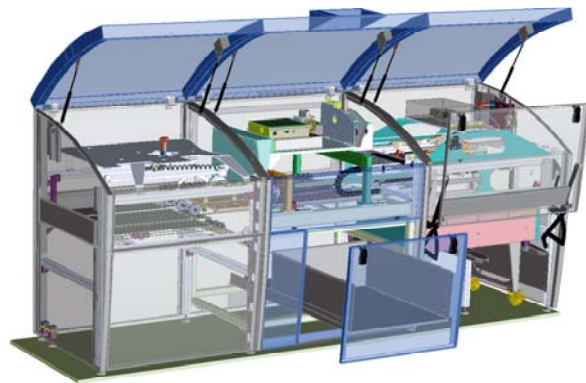

Reliable mechanics and high quality imaging

**Technical data**

Interfacing	NetLink
Imaging system	flatbed CTP
No. of imaging heads	1
Plates per cycle	1
Type of laser	Violet Laser Diode 405 nm
Resolution	1.016 – 1.270 dpi with HR option up to 2.540 dpi
Models available	LS Jet 120, 150, 170, 200, 230, 250, 300
Field updates	from LS Jet 120 -> LS Jet 300
Capacity per hour	from 120 to 300 plates / h (depending on model)
Max. plate/exposure size	640 x 940mm (25,2"x37") / 610 x 940mm (24"x37")
Plates supported	all plates available for 405 nm
Plate supply	single plate trolley / panorama plate trolley / magazine trolley for up to 3 different plate sizes
Plate supply capacity	up to 600 single / 300 panorama plates
Register system	electronic 3 pin alignment
Double Media Sensor	ultrasonic sensor for double media detection
Processor connection	straight, right, left acc. to customer`s specification
Plates leaving CTP	1 plate or 2 plates in parallel (side output)
Plate orientation	plate turning by 90°, 180°, 270° possible
Footprint	1.100 (W) x 3.500 (L) x 1.580 (H) mm
Laser Lifetime	approx. 10.000 real exposure hours
Laser upgrade	on site from green to violet or to stronger violet
NetLink	Open network interface for 1-Bit-Tiffs
NetLink	additional module NetTrack
Service Gateway	Service interface to Krause
Processor	Krause BlueFin or others

**Customer Benefit**

(Issue 09/2007)

- Connectable to any Tiff-network
- both highspeed and high quality
- no adjustments of different lasers or diodes necessary
- identical exposure position for highest plate to plate register
- investment security and upgrade path for future plate technologies
- both flexibility and high quality imaging
- meets with your individual speed requirements
- can easily be adapted to changing requirements
- highest capacity, easy managing of late deadlines
- single / panorama / commercial plate sizes
- independency from one single plate supplier or technology
- flexibility of machine in all production environments
- with large plate volumes or frequent format changes
- less operator intervention
- flexible formats and highest register accuracy
- automatic plate eject means manless operation, less downtimes
- less space necessary for the whole line
- optimized output of the plate processor
- easily adaptable to existing punch/bender alignment
- flexible and cost saving
- no laser replacement costs for years
- investment security, compatible with chemistry-free plates
- all machine setups can be changed automatically for each job such as resolution, imaging size, laser power, imaging speed etc.
- interface for exact tracking of machine status at central location
- remote service from Bielefeld around the world via internet
- Fully integrated product from one manufacturer
- or open interface for all 3rd Party processors



Krause LS Jet with fully integrated Krause BlueFin HS processor

subject to change without notice

# Krause LS Performance

## Fully automatic mid-range CTP

**KRAUSE**  
Quality builds trust.



The Krause LS Performance is designed for the mid range CTP with very small floorspace needs fitting in almost any CTP or press control room. With different speeds and mechanics based on the Krause LS Jet it is the perfect solution for fully automatic CTP production achieving highest reliability. Trolley based platehandling makes it a true daylight device for loading and production. The Juwel optics produces a very high image quality for newspaper and selected commercial CTP production. The Krause engineering and Violet technology guarantee highest reliability and lowest operating costs for the mid-range CTP market.

### Unique features and benefits provided by Krause LS Performance :

- mid-range CTP platesetter with 60mW Violet laser diode for up to 200 plates per hour
- most compact CTP device with integrated output conveyor to processor
- highest quality by Juwel optics with smallest spot size in existing newspaper plate imaging
- upgradable for future growth from 120 or 150 to 200 plates per hour
- easy Workflow integration via NetLink 1 Bit Tiff interface
- up to 600 single or 600 panorama plates online and integrated Double Media sensor
- reduced service costs with NetCare Remote Service and high quality engineering
- user friendly operation and open system design with perfect access to all components
- compatible with future Violet plate technologies



LS Performance : electronics and optics

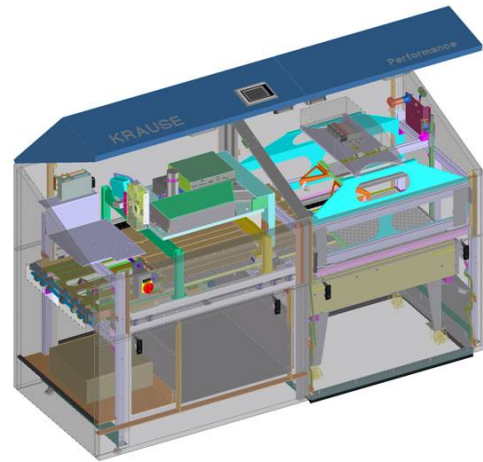

Compact design with good access to all components

**Technical data**

Interfacing	NetLink
Imaging system	flatbed CTP with Krause „Juwel Optics“
No. of imaging heads	1
Plates per cycle	1
Type of laser	violet laser diode 405 nm
Resolution	1.016 – 1.270 dpi with HR option up to 2.540 dpi
Models available	LS Performance 120, 150, 200
Field updates	from LS Performance 120 or 150 to 200 pph
Capacity per hour	from 120 to 200 plates / h (depending on model)
Max. plate size	640 x 940 mm (25,2" x 37")
Max. exposure size	610 x 940 mm (24,02" x 37")
Plates supported	all plates available for 405 nm
Plate supply	large plate trolley for single or panorama plates
Plate supply capacity	up to 600 single or 300 panorama plates
Register System	electronic 3 pin alignment
Double Media Sensor	ultrasonic sensor for double media detection
Processor connection	straight with integrated output conveyor
Footprint	1.030 (W) x 2.610 (L) x 1.600 (H) mm
Laser Lifetime	approx. 10.000 real exposure hours
Laser upgrade	on site from violet to stronger violet diodes
NetLink	Open network interface for 1-Bit-Tiffs
NetLink	additional module NetTrack
Service Gateway	Service interface to Krause
Processor	Krause BlueFin or others

**Customer Benefit**

(Issue 09/2007)

- Connectable to any Tiff-network
- high quality imaging for newspaper and commercial application
- no adjustments of different diodes necessary
- identical exposure position for highest plate to plate register
- investment security and upgrade path
- both flexibility and high quality imaging
- meets the speed requirements of all midsize newspapers
- can easily be adapted to changing requirements
- fully automatic with sufficient capacity
- single / panorama / commercial plate sizes
- Juwel Optics for highest imaging quality
- independency from one single plate supplier or technology
- easy trolley loading and full daylight operation
- capacity for a full nights production (mid range newspaper)
- flexible formats and highest register accuracy
- reduces downtime and supports manless operation
- less space necessary for the whole line
- smallest footprint of its class for reduced space costs
- no laser replacement costs for years
- investment security, compatible with chemistry-free plates
- all machine setups can be changed automatically for each job such as resolution, imaging size, laser power, imaging speed etc.
- interface for exact tracking of machine status at central location
- remote service from Bielefeld around the world via internet
- Fully integrated product from one manufacturer
- or open interface for all 3rd Party processors



Krause LS Performance with BlueFin processor

subject to change without notice

# Krause BlueFin

## A new era of processing

**KRAUSE**

Quality builds trust.



The Krause BlueFin is a heavy duty plate processor for polymer plates which comes in two models for the mid-segment and the high-end market. It offers extremely high production stability and therefore contributes to a huge extent to the stability of the whole prepress process. BlueFin ensures constant developing results covering the quality standards modern newspaper printers are looking for such as high resolution and stochastic screening e.g. A sophisticated control system surveys all relevant production parameters and thus fulfils the needs of an automatized, industrial plate production. A high operator convenience with a modern PLC control as well as easy maintenance and an easy reproduction of the critical settings are further key features of BlueFin, being the **fastest plate processor in the world**. BlueFin reduces your costs per plate due to less energy and chemistry consumption, less waste plates, higher production availability or reduced spare parts costs and usage of equal parts such as upper and lower rollers. BlueFin is prepared for the chemical-free plates of the actual generation.

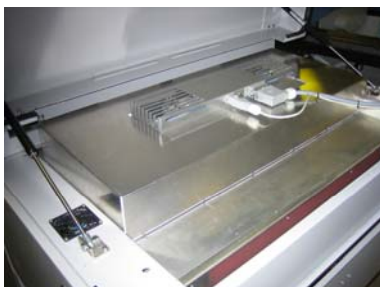

**Fast, precise and effective PreHeat**

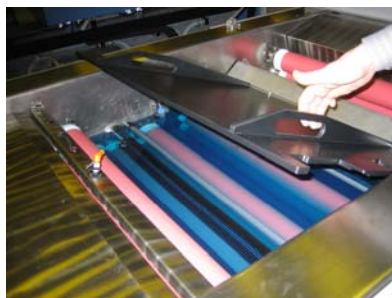

**Easy maintenance, low consumption**



**Heavy duty: production stability**



**Technical Data**

**Customer Benefit**

(Issue 09/2007)

General specs	<p>designed for all common polymer plates</p> <p>designed for all common chemistry-free plates</p> <p>working width 650 mm</p> <p>plate thickness 0.25 – 0.4 mm</p> <p>processing speed 80 – 240 cm / min</p> <p>basins all made of stainless steel</p> <p>roller diameter of 80 mm</p>	<p>good choice of plates and consumables from different suppliers</p> <p>good choice of plates and consumables from different suppliers</p> <p>covers all common newspaper plate sizes</p> <p>covers all common newspaper plate thicknesses</p> <p>high-speed developing for up to 320 plates per hour</p> <p>heavy duty design for high production security</p> <p>heavy duty design for high production security</p>
PreHeat	<p>less than 9 minutes start-up time from cold</p> <p>+/- 2° C over the whole plate</p> <p>Retrofit-Kit, simple to take in and out</p>	<p>quick start-up time saves time and money</p> <p>suitable for high quality application and screenings</p> <p>high availability of the plate processor for production</p>
PreWash	<p>Brush pressure/speed can be adjusted precisely</p>	<p>no bad influence on the process result, min. overcoat transport</p>
Developing section	<p>83 cm bath length</p> <p>78 l volume for developer</p> <p>dwelt time of 24 sec. at 210 cm / min</p> <p>anti-oxidation cover</p> <p>min. plate length of 290 mm</p> <p>brushes working against rollers</p>	<p>allows plate output of up to 320 plates per hour</p> <p>for high throughput and optimized lifetime of developer</p> <p>plate is properly developed even at high speed</p> <p>about 10% longer life-time of developer</p> <p>covers all common newspaper plate sizes</p> <p>better developing results, very precise adjustment</p>
Gumming, drying	<p>gumming with spiral felt roll</p> <p>drying without heating</p>	<p>defined gum thickness</p> <p>cool plates, less register problems, reduced energy consumption</p>
Power consumption	<p>3-4 kW</p>	<p>up to 50% energy cost reduction</p>
Weight	<p>950 kg empty, 1100 kg filled</p>	<p>heavy duty design for long life</p>

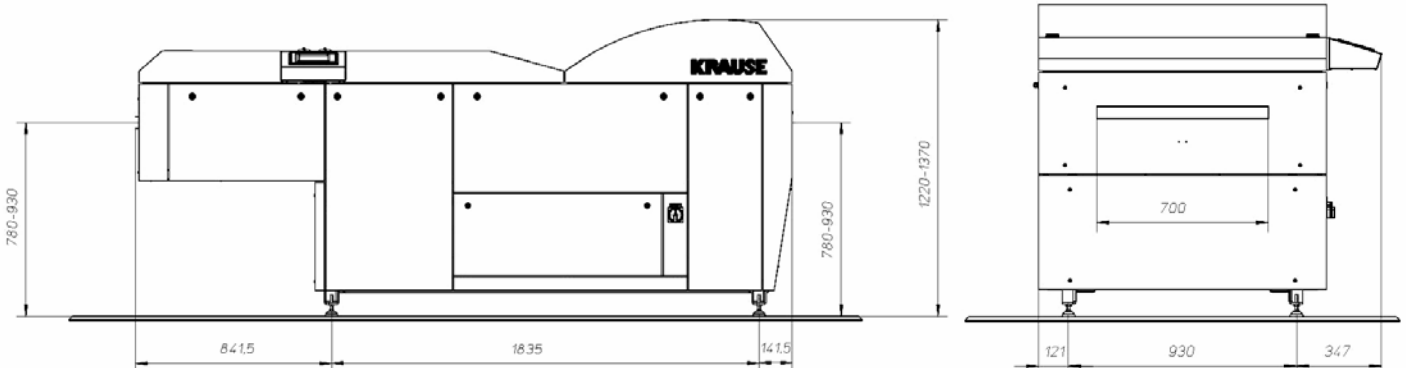

subject to change without notice